

Archer Rapid Gate

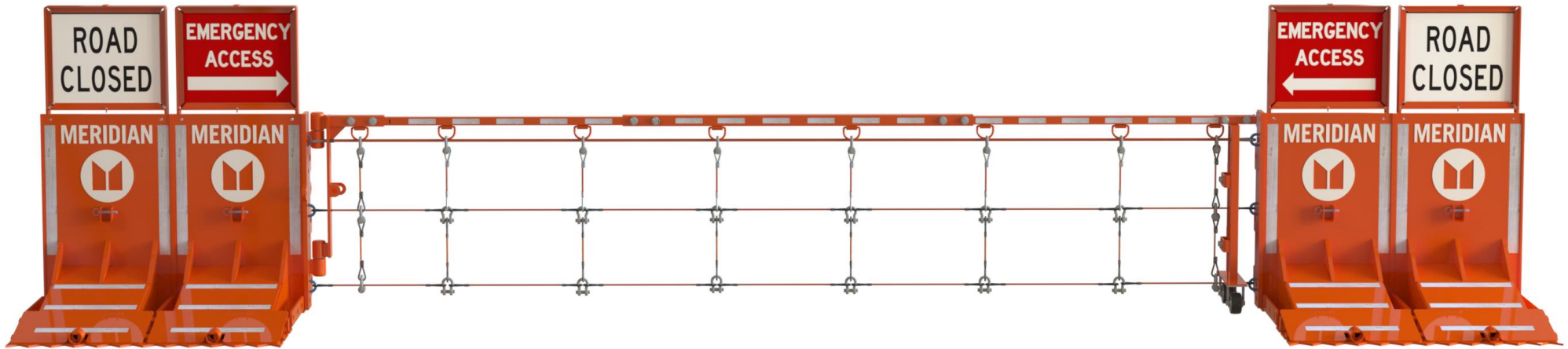

FEATURES

- Expandable to 10 ft., 12 ft., and 14ft.
- Fast to assemble
- Ideal for road closures
- Great for construction sites
- Crash certified ASTM P2 rating!
- #1 emergency access gate

180 Degree Horizontal Rotation

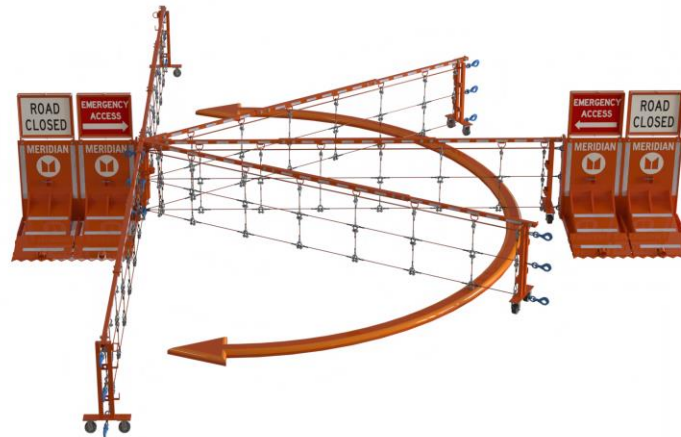

MUTCD

The Archer Rapid Gate is designed to be visible on roads by using bright Traffic Orange paint and HIP reflective decals. The directional signage is all MUTCD approved.

WE OFFER RENTAL AND PURCHASING OPTIONS! GIVE US A CALL TO DISCUSS YOUR NEEDS (434) 529-6903



MERIDIAN
RAPID DEFENSE GROUP



Archer Rapid Gate Components

4 - Archer1200 Barrier



1 - Pivot Plate



1 - Receiver Plate



1 - Archer Rapid Gate Leg



1 - Archer Hauler 2.0

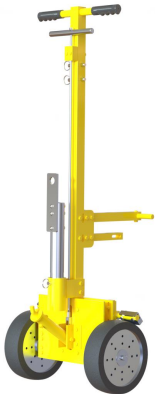

4 - Archer Wayfinding Frames



4 - Wayfinding Frame Inserts



Rapid Gate Net

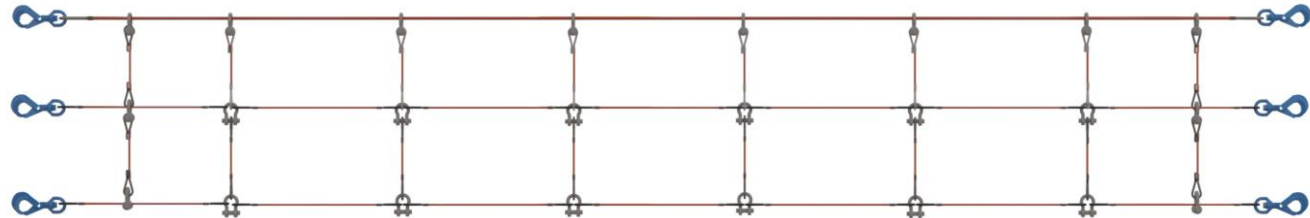

10 ft. Connector



12 ft. Connector



14 ft. Connector



L Beam



R Beam



1 -Transportation Cart



1 -14 ft. Main Cable- 174 in.



1 -12 ft. Main Cable- 147 in.



1 -10 ft. Main Cable- 123 in.



Archer 1200 Specifications



Archer 1200 Dimensions

- Length- 48 in.
- Width- 24 in.
- Height- 57 in.
- Weight- 680 lbs.
- Surface Area- 11,288 square in
- Material- ASTM A36 steel/AR500

Powder coat Specifications

- Gloss 60° angle (ASTM D-523-89) 80+
- Hardness (ASTM D-3363-92A) H – 2H
- Flexibility (ASTM D-1737-89) 1/8 inch
- Adhesion (ASTM D-3359-95A) 5B
- Impact direct/indirect (ASTM D-2794-93) 120 in-lbs.
- Salt Spray (ASTM B117) 1000 Hrs.

Caster Wheel Specifications

- Type- Black soft rubber tread, crowned profile
- Core Material- Aluminum core
- Wheel Diameter- 10 in.
- Wheel Width- 2.25 in.
- Capacity- 400 lbs.

Archer Rapid Gate Specifications

1



2

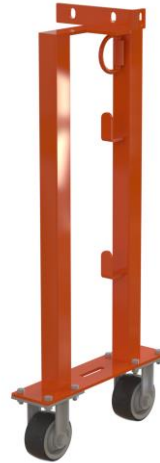

3



Item #	Component	Length	Width	Height	Weight	Material
1	Pivot Plate	36.30 in.	9.29 in.	14.86 in.	82.0 lbs.	ASTM A36 steel
2	Archer Rapid Gate Leg	35.90 in.	16.0 in.	7.66 in.	21.60 lbs.	ASTM A36 steel
3	Receiver Plate	36.30 in.	7.37 in.	0.75 in.	46.78 lbs.	ASTM A36 steel

- Easily bolt onto any Archer 1200 Barrier
- Heavy duty gauge steel used 3/4"
- Durable powder coating prevents corrosion
- Each hinge can support up to 3000 lbs.
- The barrel is 2-1/2" diameter
- Heavy duty smooth glide caster supports 800 lbs. each

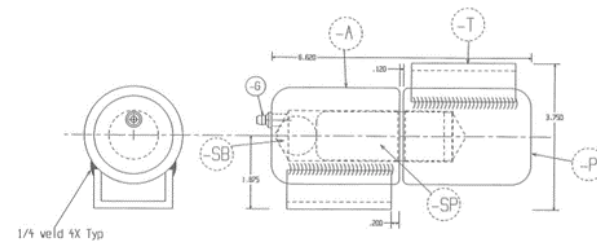

Archer Rapid Gate Beam Specifications

Item #	Component	Length	Width	Height	Weight	Material
4	Beam L	57.5 in.	1.75 in.	5.0 in.	12.39 lbs.	ASTM 1011 steel
5	Beam R	57.5 in.	1.75 in.	5.0 in.	12.9 lbs.	ASTM 1011 steel
6	10 ft. Connector	17.0 in.	2.0 in.	2.0 in.	3.81 lbs.	ASTM 1011 steel
7	12 ft. Connector	41.7 in.	2.0 in.	5.0 in.	10.0 lbs.	ASTM 1011 steel
8	14 ft. Connector	66.5 in.	2.0 in.	5.0 in.	16.2 lbs.	ASTM 1011 steel

4



5



6



7



8



- Easily adjustable via telescoping
- Corner welded for smooth telescoping action
- Inline zinc coating complies with AASHTO M-120
- Durable powder coating prevents corrosion
- Each D-ring can support 4080 lbs.
- Easily identifiable tubes with cutout
- HIP reflective tape aids in visibility at night or low light conditions

Archer Rapid Gate Net Specifications

14 ft. Main Cable- 174 in.



12 ft. Main Cable- 147 in.



10 ft. Main Cable- 123 in.



14 ft. Archer Rapid Gate Net

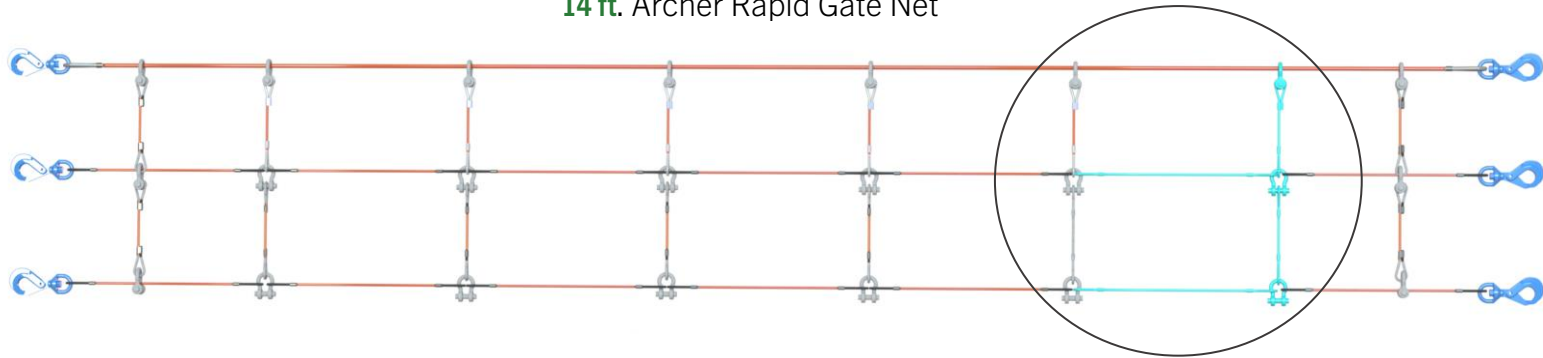

The net is connected using shackles that can be removed to create either a 10 ft. net, 12 ft. net or 14 ft. net. In the figure above is a 14 ft. net and highlighted in blue are the components that need to be removed to create a 12 ft. net.

Archer Rapid Gate Net Specifications

- The Meridian Archer Rapid Gate net uses technology from aircraft carriers to absorb the kinetic energy of a moving vehicle and pulls the barriers into play for vehicle mitigation without loss of life.
- The net is expandable to ten feet, twelve feet, and fourteen feet.
- The Archer Rapid Gate net is manufactured using only the highest grade extra improved plowed steel and vinyl coated in neon yellow that aids in visibility as well as abrasion protection and flexibility.
- Each wire rope cable is attached to the barriers by two G-100 Swivel self-locking hooks. The self-locking hooks each have a working load limit of 5,700 pounds and can swivel during load.



Wire Rope Cable Specifications

- Construction- 6x19 IWRC
- Nominal Diameter-0.625 in & 0.375 in.
- Finish- Galvanized
- Lay Direction- RHRL
- Specification- ASTM A 1023 or RR-W410G
- Grade of Steel Used- EIPS
- Min. Breaking Strength- 24,004 lbs.

Wire Rope Cable Chemical Composition

- C: 0.69-0.73%
- Si: 0.200.024%
- S: Max 0.025%
- P: Max 0.025%
- Mn: 0.54-0.64%
- P: Max 0.025%
- Mn: 0.54-0.64%

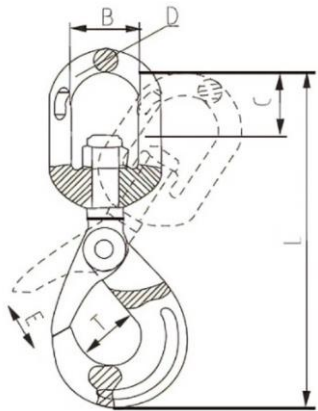

G-100 Swivel Hook Specifications

- Weight- 2.6 lbs.
- Quenched and tempered alloy steel
- EN 1677-3 & ASME B30.26, PAS1061
- Full swivel under load
- Federal Specification RR-C-271G Type IVA, Grade A, Class 2

G-100 Specifications Dimensions

- B- 1.42 in.
- C- 1.44 in.
- D- 0.51 in.
- T- 1.35 in.
- L- 7.35 in.
- E- 1.28 in.

Archer Rapid Gate Transportation Cart Specifications



Transportation Cart Specifications

- Length- 48 in.
- Width- 24 in.
- Height- 22 in.
- Weight- 196.7 lbs.
- Compatible with the Archer Hauler 2.0
- Durable powder coating for corrosion resistance
- Heavy duty gauge steel for a long service life

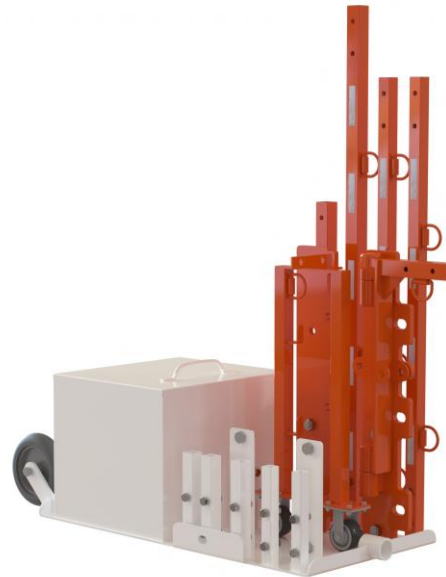

- Accommodates one Archer Rapid Gate kit or two Archer Rapid Gate kits



- Easily store the Rapid Gate net and Wayfinding Signs on the transportation cart

Archer Hauler 2.0 Specifications

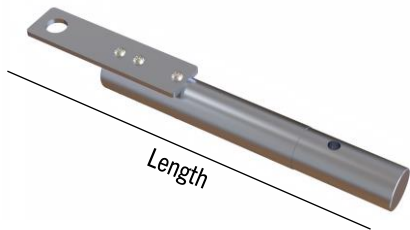

Archer Hauler Attachment Specifications

- Length- 18 in.
- Diameter- 2.0 in.
- Weight- 4 lbs.
- Material- Aluminum 6061-T6

Archer Hauler 2.0 Dimensions

- Length- 18 in.
- Width- 12 in.
- Height- 53 in.
- Weight- 40 lbs.
- Material- Aluminum 6061-T6

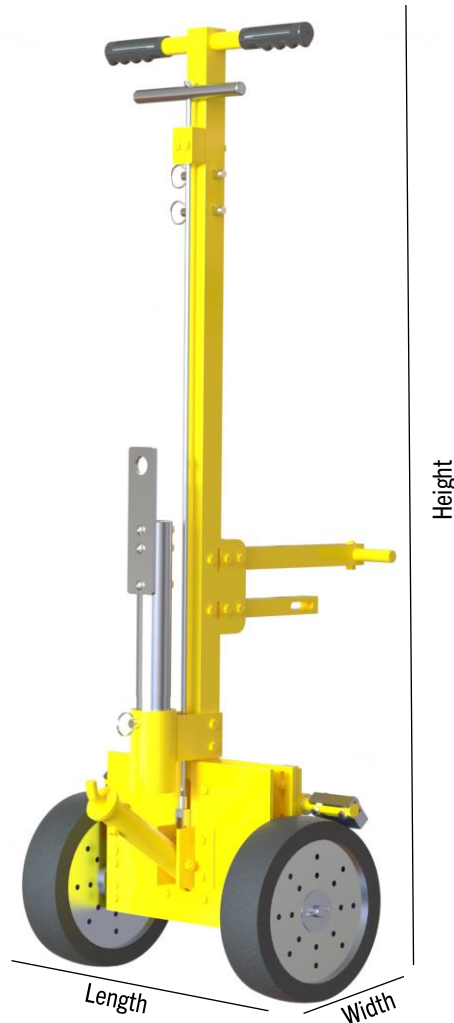

Caster Wheel Specifications

- Type- Black solid core tire
- Core- Stainless steel core
- Wheel Diameter- 10 in.
- Wheel Width- 2.25 in.
- Capacity- 900 lbs.

Features

- Adjustable brakes
- 3,000 lb. capacity
- Solid core tire
- Durable powder coating

Archer Hauler 2.0 Ergonomic Data						
Product	Initial Force 1	Initial Force 2	Initial Force 3	Initial Force 4	Average Force to move barrier	Force on an incline (7 degrees)
Archer Hauler 2.0	22.4 lbf	25.3 lbf	21.8 lbf	21.6 lbf	23 lbf	42 lbf

Archer Wayfinding Frame Specifications



- Custom RAL color options available



- Ideal solution to convey your message



Archer Wayfinding Frame Dimensions

- Length- 24.25 in.
- Width- 22.25 in.
- Depth - 2 in.
- Weight- 9 lbs.
- Material - Aluminum T6

Wayfinding Frame Hardware Specifications

- **2-** 1/2"-13 steel hex nut
- **4-** 1/2" stainless steel washer
- **2-** 1/2"-13 Thread size ,2-1/2" long steel screw
- **2-** 1/4" Diameter, 2-1/16" usable length quick release pin

Scan for more information



Archer Wayfinding Frame Signs Specifications



Wayfinding Sign Dimensions

- Length- 21.35 in.
 - Width- 18.25 in.
 - Depth - 0.16 in.
 - 4 Wayfinding signs
 - Material- Coroplast
- The four standard signs that come with the Archer Rapid Gate are
 - 2 Emergency Access Signs
 - 2 Road Closed Signs
 - Upon request we can provide other custom wayfinding signs as well.

Archer Rapid Gate Overall Length

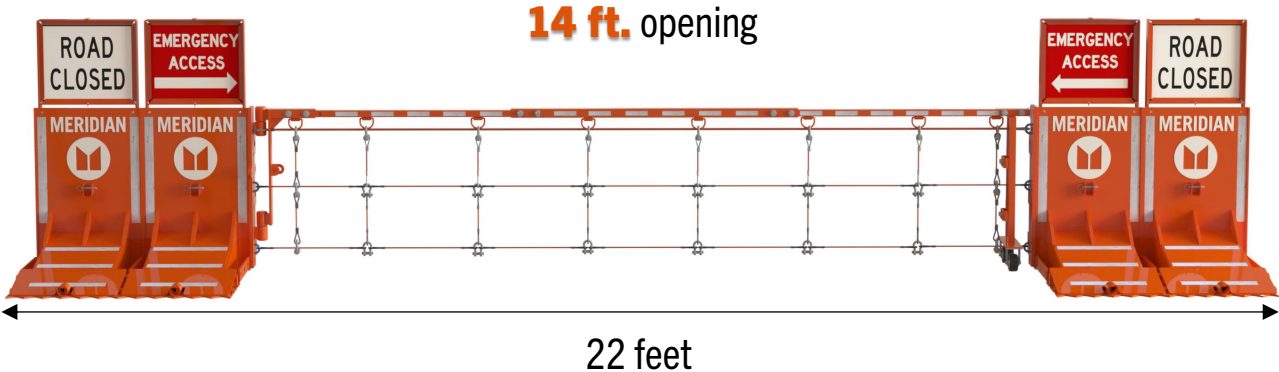
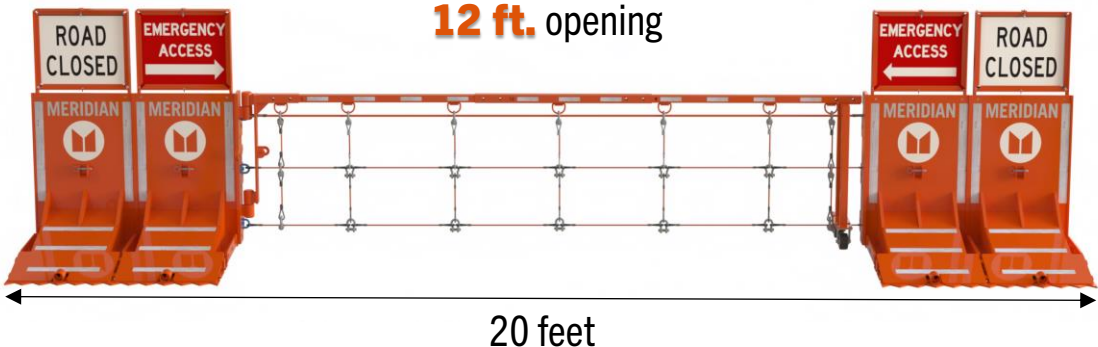
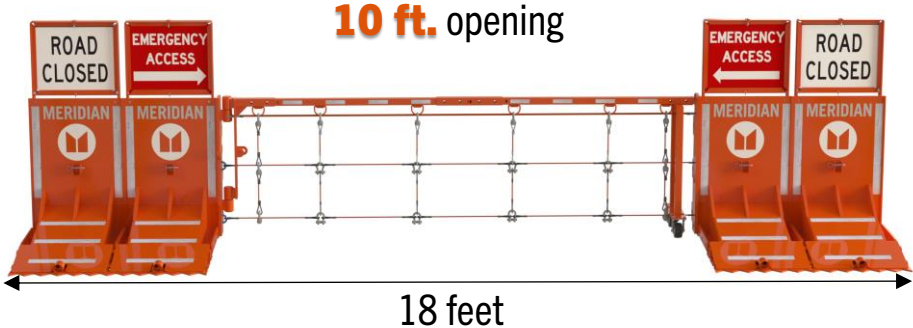

Archer Rapid Gate Specifications

Component	Length	Width	Height	Weight
Beam L	57.5 in.	1.75 in.	5.0 in.	12.39 lbs.
Beam R	57.5 in.	1.75 in.	5.0 in.	12.9 lbs.
10ft Connector	17.0 in.	2.0 in.	2.0 in.	3.81 lbs.
12ft Connector	41.7 in.	2.0 in.	5.0 in.	10.0 lbs.
14ft Connector	66.5 in.	2.0 in.	5.0 in.	16.2 lbs.
Pivot Plate	36.30 in.	9.29 in.	14.86 in.	82.0 lbs.
Receiver Plate	36.30 in.	7.37 in.	0.75 in.	46.78 lbs.
Wayfinding Frame	24.21 in.	22.29 in.	2.25 in.	7.61 lbs.
Wayfinding Signs	21.40 in.	0.16 in.	18.0 in.	0.3 lbs.

Component	Length	Width	Height	Weight	Capacity
Transportation Cart	58.0 in.	24.0 in.	38.0 in.	198 lbs.	
Wayfinding Box	23.45 in.	20.8 in.	38.0 in.		7.14 cubic feet
Archer Rapid Gate Net Box	20.8 in.	7.0 in.	38.0 in.		38 marketing inserts

Archer Rapid Gate	Total Weight – 3,238 lbs.
Archer Rapid Gate Total Width at 10 ft. openings	18 ft.
Archer Rapid Gate Total Width at 12 ft. openings	20 ft.
Archer Rapid Gate Total Width at 14 ft. openings	22 ft.

**Installation
Manual**

